



65-007-XX - Pipe To Hose Adapter



Overview

Single-piece construction and cast-in wrench flats make installation easier. 85-5-5-5 bronze. Some sizes also available in British Threads (BSP).

Dimensions

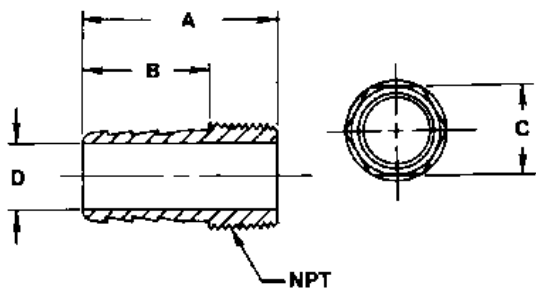

Number	NPT	Hose Size	A	B	C	D	WT/100
	in./mm.		in./mm.	in./mm.	in./mm.	in./mm.	lb./kg.
65-007-56	1/2 15	1/2" or 5/8"	2.580 65.532	1.630 41.402	0.870 22.098	0.400 10.160	18 8.165
65-007-51	3/4 20	3/4"	1.930 49.022	1.000 25.400	0.870 22.098	0.510 12.954	23 10.433
65-007-52*	1 25	1"	2.250 57.150	1.130 28.702	1.120 28.448	0.800 20.320	34.8 15.785
65-007-53*	1-1/4 32	1 1/4"	2.690 68.326	1.440 36.576	1.370 34.798	1.030 26.162	61.2 27.760
65-007-54*	1-1/2 40	1 1/2"	2.630 66.802	1.440 36.576	1.620 41.148	1.280 32.512	81.8 37.104
65-007-55*	2 50	2"	2.880 73.152	1.630 41.402	2.120 53.848	1.750 44.450	130.5 59.194
65-006-49*	2-1/2 65	2 1/2"	3.620 91.948	2.000 50.800	2.620 66.548	2.250 57.150	194.4 88.178
65-007-79	3 80	3"	5.060 128.524	3.000 76.200	3.125 79.375	2.600 66.040	341 154.675
65-007-80	4 100	4"	6.500 165.100	3.900 99.060	4.125 104.775	3.500 88.900	881 399.615

*Also available in British threads (BSP)